

**GENERAL****SHEET 350-7**

DATED: 6-2-75

## SPLITTER MOUNTED GUARD NO. 350-7 FOR 10" TILTING ARBOR SAW

This guard may be lifted from the saw, swung to one side and lowered at the rear of the machine permitting dadoing and moulding and permitting an unobstructed and clear saw table. It can be just as conveniently put back in place again, to serve as blade guard and splitter. It never needs to be removed or taken from the saw and hung on the wall or shelf.

The guard is a splitter mounted type of saw guard. The splitter is fitted with anti-kick back fingers of different length. Due to the fact that this guard raises or lowers by pivoting around a point well back, it is possible to make the guard ride the work with little effort. Even when the saw is tilted at 45 degrees. The splitter is attached to the rear trunnion of the saw, however for additional rigidity it is also fastened to a bracket behind the saw.

To mount the guard, proceed as follows: Remove the saw blade and attach the front bracket No. 357-12 to the rear trunnion. Place support rod ~~357-15~~ into rear trunnion, and tighten in place by screw P-7.

Attach adjustable brackets 357-14 and 357-13 to support rod. The vertical face of the bracket must be parallel with the saw arbor face and both the front and rear bracket screw must fit into the splitter slot and hole.

Clamp splitter in place, both front and rear by screws P-35 and P-132. Before using, be sure to check the alignment. It is necessary that the splitter be aligned perfectly with the blade, in order to avoid cramping. It is also important that the rip fence be perfectly parallel to the saw blade and splitter. If any misalignment occurs, make the necessary adjustments to prevent the work from leading away from the rip fence or binding against it. Any slight misalignment of the splitter will cause difficulty. **It is important** that it be adjusted properly.

The front bracket 357-12 and rear bracket 357-13 are adjustable. Oversize holes in these brackets allow sufficient lateral movement to assure proper adjustment.

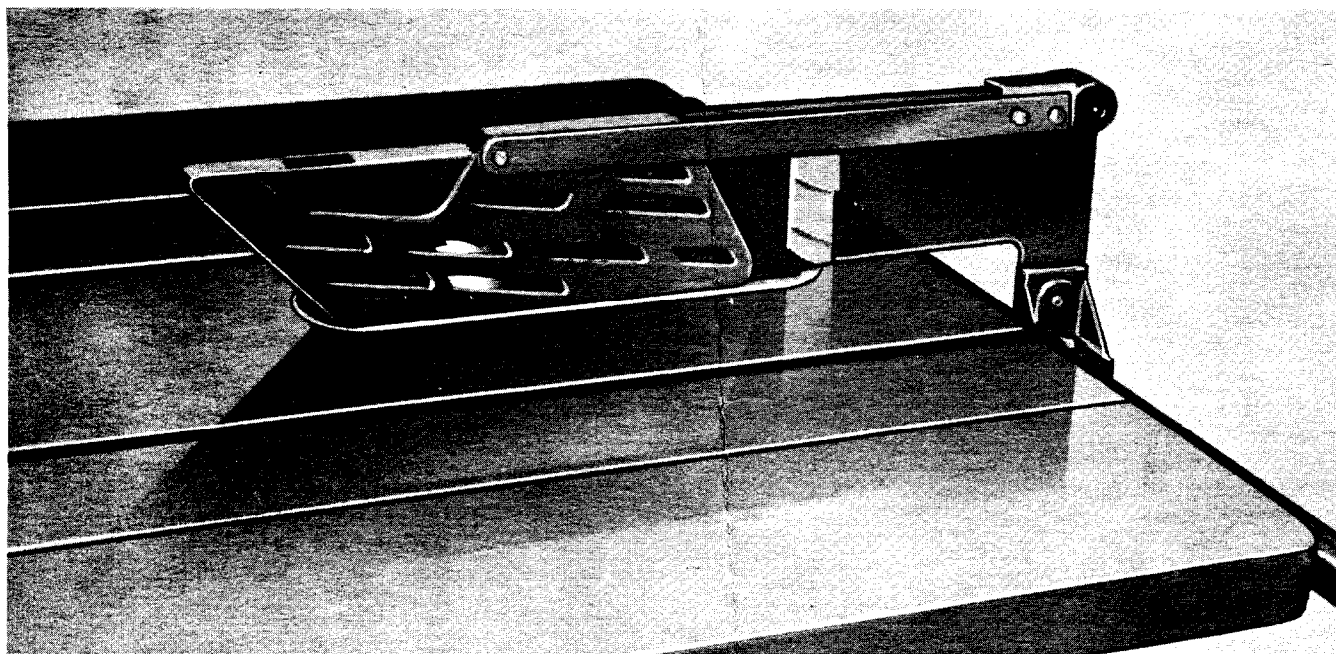

**GENERAL MANUFACTURING CO. LTD.**  
DRUMMONDVILLE, QUE., CANADA

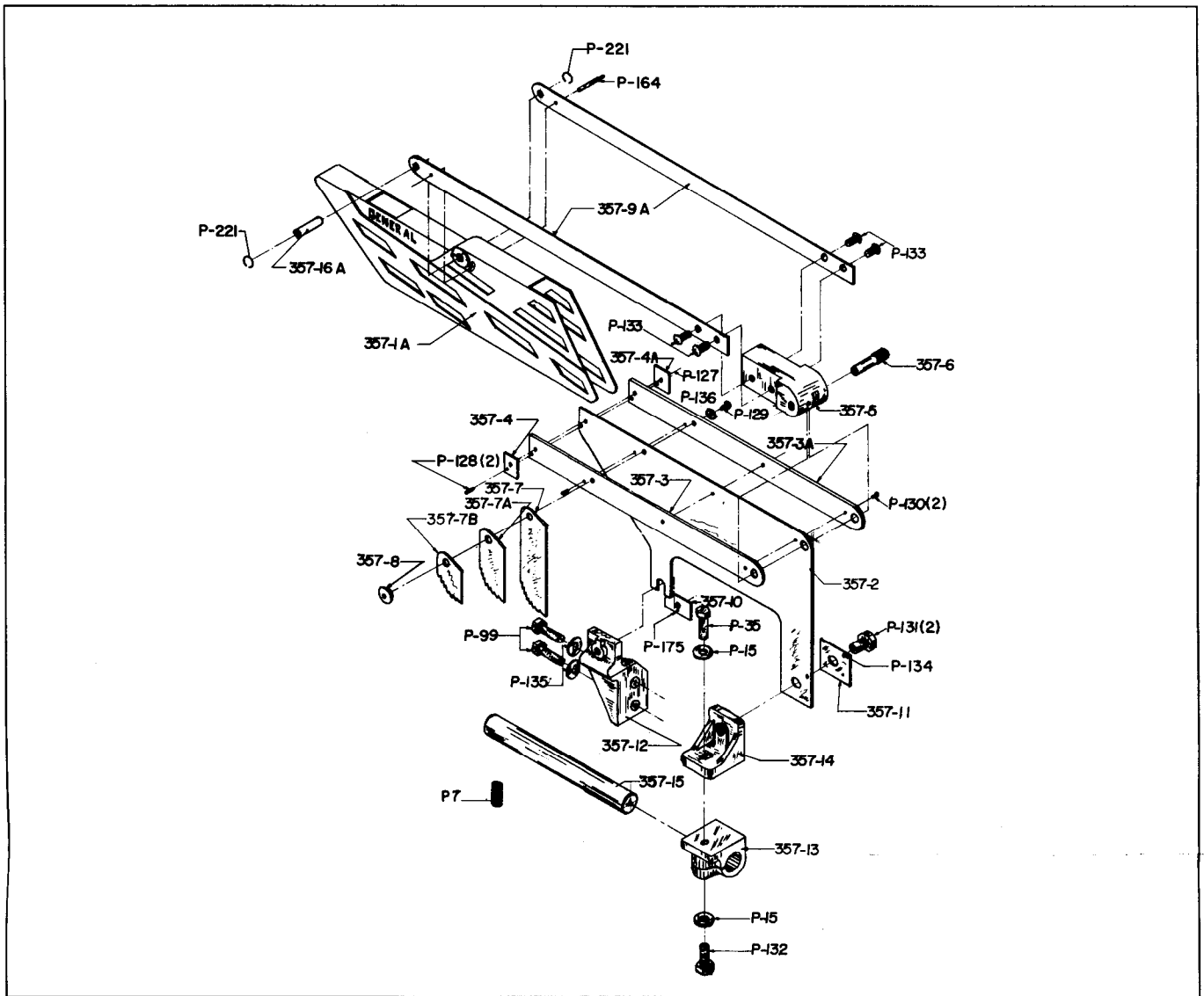

## REPLACEMENT PARTS

**IMPORTANT** When ordering parts always give both the part number and the description of each item; also the serial number of arbor saw on which the parts are to be used.

Part No.	Description	Quant.	Part No.	Description	Quant.
357-1A	Guard bracket	1	357-15	Support rod	1
357-2	Splitter	1	357-16A	Sleeve	1
357-3	Right bar	1	P-99	Hex. H. Screw 5/16" x 1"	2
357-3A	Left bar	1	P-135	Lock Washer 5/16"	2
357-4	Right spacer	1	P-131	Hex. H. Screw 3/8" x 3/4"	2
357-4A	Left spacer	1	P-128	Groov. Pin-Type 2-3/16" x 1/2"	2
357-5	Arm hinge	1	P-7	Socket Set Screw 5/16" x 5/16"	1
357-6	Pin	1	P-132	Hex. H. Screw 3/8" x 1-1/4"	1
357-7	Kickback finger	1	P-15	Lock Washer 3/8"	2
357-7A	Kickback finger	1	P-35	Hex. H. Screw 3/8" x 1"	1
357-7B	Kickback finger	1	P-134	Groov. Pin-Type 1-3/16" x 3/8"	1
357-8	Finger pivot	1	P-130	F.H. Screw 10-32 x 1/4"	2
357-9A	Guard arm	2	P-129	R.H. Screw 1/4" x 5/8"	2
357-10	Front clamp plate	1	P-133	R.H. Screw 1/4" x 1/2"	4
357-11	Rear clamp plate	1	P-136	Lock Washer 1/4"	5
357-12	Front bracket	1	P-221	Circlips 5100-31	2
357-13	Rear bracket	1	P-164	Groov. Pin-Type 2-3/16" x 1-1/4"	1
357-14	Rod bracket	1	P-127	F.H. Screw 10-32 x 1/2"	1

# GENERAL MFG. CO. LTD.

**MANUFACTURER OF CIRCULAR SAWS, BAND SAWS, WOOD LATHES, PLANERS, JOINTERS, MORTISERS, DRILL PRESSES, SHAPERS, AND SANDERS.**