

No. 200
STANLEY CUTTER AND CHISEL GRINDER

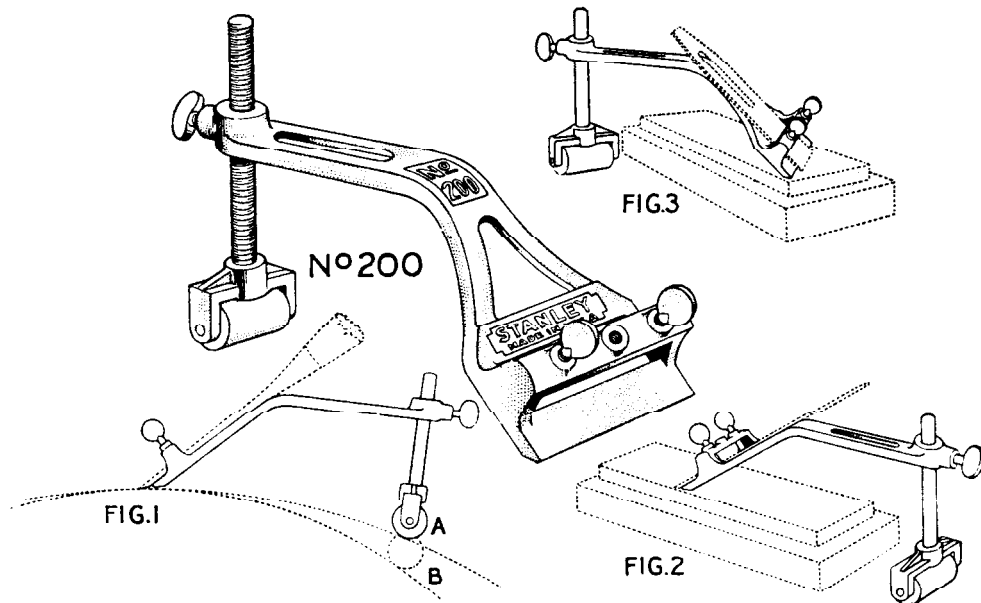

The **STANLEY CUTTER AND CHISEL GRINDER** is a fixture for holding Plane Irons, Chisels and similar cutting tools so that they may be ground or honed to any desired angle or bevel, with an accuracy that is very difficult to obtain when a tool is held by hand.

As shown in the cut the Grinder is fitted with two thumb screws and three thumb screw holes. By the use of two thumb screws, the tool to be ground is held firmly in the fixture. When wide cutters are to be held, place the thumb screws in the two outer holes. For narrow cutters, use the middle hole, or the middle hole and one of the outer holes.

The angle at which the edge of the tool is to be sharpened is obtained by raising or lowering the roller. By tightening the roller bar thumb screw, a brass lug is forced against the roller bar, maintaining the initial set without damaging the machine screw threads of the bar.

In grinding, hold the Roller, and beveled edge of the tool to be sharpened, against the face of the grindstone as in Fig. 1; "A" indicating the position of the Roller. "B" indicates the position of the roller on a stone of smaller diameter, both positions giving the same bevel to the tool being sharpened.

In honing, the Roller does not come in contact with the oil stone but acts as a rear support. (See Fig. 2.)

By turning the Roller at an angle to the main body (see Fig. 3), the user will be able to obtain the slanting stroke so commonly used when tools are sharpened without a holder.

The Grinder is made entirely of metal, with all parts nickel plated.

IMPORTANT

The proper bevel for grinding Plane Irons or Chisels is at an angle of about twenty-five degrees. Tools are so ground when they leave our factory. This angle should be observed when re-grinding or re-honing.



THE STANLEY RULE & LEVEL PLANT.
THE STANLEY WORKS
NEW BRITAIN, CONN. U.S.A.